

## Instructions for use

Replacing the seal on aerosol-tight rotors (Centrifuge 5420/5425)

English (EN)

These instructions for use are a supplement to the manual of the centrifuge and do not replace it. Please read the centrifuge operating manual as well before putting it into operation after replacing the seal. The current version of the manual can be found on the Internet under [www.eppendorf.com/manuals](http://www.eppendorf.com/manuals).

## 1 Safety notes

---



### **DANGER! Electric shock due to the ingress of liquid.**

- ▶ Switch off the device and disconnect it from the mains/power line before starting cleaning or disinfection.
- ▶ Do not allow any liquids to penetrate the inside of the housing.
- ▶ Do not perform a spray clean/spray disinfection on the housing.
- ▶ Only reconnect the device to the mains/power line when it is completely dry, both inside and outside.



### **WARNING! Risk of injury from improperly attached rotors, rotor lids and caps.**

- ▶ Only centrifuge with firmly tightened rotor and rotor lid as well as with inserted buckets and correctly closed caps.
- ▶ If unusual noises occur when the centrifuge starts, the rotor, rotor lid or a cap may not be properly secured. Immediately press the **start/stop** key to stop centrifuging.



### **CAUTION! Risk of injury when turning the rotor manually.**

- ▶ When turning a swing-bucket rotor, pay special attention to ensure that your fingers do not get jammed or get caught on the swinging buckets.



### **CAUTION! Risk of injury due to chemically damaged rotor lids or caps.**

Transparent rotor lids or caps made from PC, PP or PEI may lose their strength under the impact of organic solvents (e.g., phenol, chloroform).

- ▶ If rotor lids or caps have come into contact with any organic solvents, they should be cleaned immediately.
  - ▶ Check the rotor lids and caps regularly for any damage and cracks.
  - ▶ Immediately replace any rotor lids or caps which show cracks or milky stains.
-

## Instructions for use

### 2 Replacing the seal on aerosol-tight rotors (Centrifuge 5420/5425) English (EN)

#### 2 Replacing the seal on the rotor lid

##### Prerequisites

The rotor lid has been removed in accordance with the operating manual for the centrifuge.

##### Recommended cleaning agents:

- Alcohol 70% (ethanol, isopropanol)
- Mild neutral cleaning agent

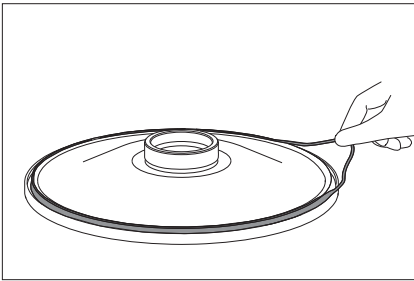

1. Remove and dispose of the old sealing ring.
2. Thoroughly clean the groove for the sealing ring.
3. Clean and disinfect the rotor lid using the recommended cleaning agents.
4. Rinse the rotor lid thoroughly with distilled water.

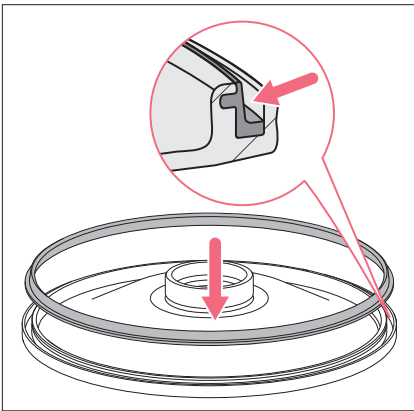

5. Moisten the sealing ring with clean water.
6. Insert the sealing ring exactly in the clean and dry groove of the rotor lid.
7. Press the sealing ring into the lateral groove, around the entire circumference of the rotor lid.
8. Place the rotor lid with the underside facing upwards on a cloth.
9. Leave the rotor lid to dry for 5 – 10 minutes.
10. Perform a visual inspection.  
The seal must be flush with the groove of the rotor lid around the entire circumference and must not protrude at any point.
11. Fit the rotor lid on the rotor.
12. Leave the rotor lid open when the rotor is not being used.



The rotor lid cannot close properly if the sealing ring is not correctly inserted.

**Instructions for use**  
 Replacing the seal on aerosol-tight rotors (Centrifuge 5420/5425)  
 English (EN)

**3 Ordering information**

<b>Order no. (International)</b>	<b>Order no. (North America)</b>	<b>Description</b>
5495 501.002 5495 401.008	5495501002 5495401008	<b>Rotor lid FA-24x2</b> aerosol-tight, aluminum aerosol-tight, aluminum
5495 506.004	5495506004	<b>Rotor lid FA-10x5</b> aerosol-tight, aluminum
5495 509.003	5495509003	<b>Rotor lid FA-18x2-KIT</b> aerosol-tight, aluminum
5495 515.003 5495 516.000	5495515003 5495516000	<b>Seal for rotor lid</b> FA-24x2 (Centrifuge 5420, 5425) FA-10x5, FA-18x2-Kit (Centrifuge 5425)
5810 350.050	022634330	<b>Pivot grease</b> Tube 20 mL