

# Corning® Aspirator

CORNING

Instruction Manual

Catalog Number:  
4930



## Table of Contents

1.0 Product Description .....	1
2.0 Packing.....	1
3.0 Set Up.....	2
4.0 Aspirator Operation.....	3
5.0 Cleaning and Service.....	3
6.0 Aspirator Attachment Options.....	4
7.0 Chemical Compatibility .....	5
8.0 Spare Parts .....	6
9.0 Limited Warranty .....	7

## 1.0 Product Description

The Corning® Aspirator is an aspiration device used for the removal of liquids from a variety of lab vessels. It is designed for use with an in-house vacuum system. The aspirator allows precise fingertip control of aspiration and presents a sensible alternative to the use of glass pipets for supernatant disposal.

Designed for a comfortable fit in either hand, the aspirator can be used with a variety of collection devices. These include some glass pipets, 2 mL plastic pipets (Cat. No. 4020, 4021, 4486) or 2 mL aspiration pipets (Cat. No. 9186). Included with the aspirator is a single-channel adapter (Cat. No. 155850) for use with standard 1 to 200  $\mu$ L disposable pipet tips (Cat. No. 4804, 4860, 4864), as well as a rubber adapter for glass pipets (Cat. No. 155505).

An 8-channel adapter for standard 1-200  $\mu$ L disposable pipet tips is available for use with 96-well microplates.

## 2.0 Packing

Description	Qty/Pk
Aspirator	1
Single-channel adapter	1
Rubber adapter for glass pipets	1

### 3.0 Set Up

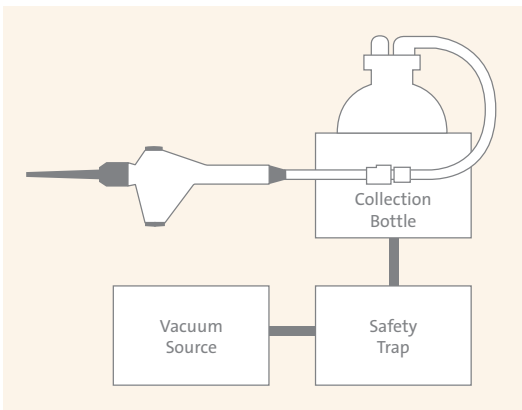

The aspirator is designed for use with a vacuum pump or an in-house vacuum system and a suitable collection vessel.

Connect the hose barb end of the aspirator handpiece to flexible 4 mm I.D. thick wall (to prevent collapsing under vacuum) silicone rubber tubing, and then connect the other end to a suitable collection vessel. These heavy wall filter flasks have a protective PVC coating that helps prevent the glass from shattering. They are autoclavable (121°C) and resistant to thermal shock. The collection vessel is then connected by tubing to the vacuum source. **NOTE:** When working with infectious materials, connecting a second vessel or 50 mm hydrophobic membrane disc filter (Cat. No. 431227) as an in-line safety trap between the collection vessel and the vacuum source is strongly advised.

The aspirator is supplied with a soft rubber grommet which holds both glass and plastic 2 mL pipets. To use the single-channel pipet tip adapter, simply remove the orange fastening sleeve from the aspirator handpiece by turning one-quarter turn counterclockwise, take out the rubber grommet, and replace with the tip adapter, which has its own fastening sleeve. Tighten with a clockwise one-quarter turn.

To connect the 8-channel adapter for disposable tips, remove the fastening sleeve and rubber grommet, and replace with the 8-channel adapter which has its own fastening sleeve.

## 4.0 Aspirator Operation

Vacuum pressure through the aspirator is controlled by the pressure-sensitive orange control button on the top of the handpiece.

Using the plastic screw opposite the control button, you can set a residual vacuum level to prevent waste liquids dripping from the tip or the pipet. The aspirator is factory preset to allow a low level of constant suction; by turning the screw one full turn clockwise, the valve is shut and residual vacuum is stopped.

## 5.0 Cleaning and Service

The aspirator is entirely autoclavable. When working with biohazardous material, sterilize the unit before disassembling for cleaning. Refer to the diagram (below) for disassembly.

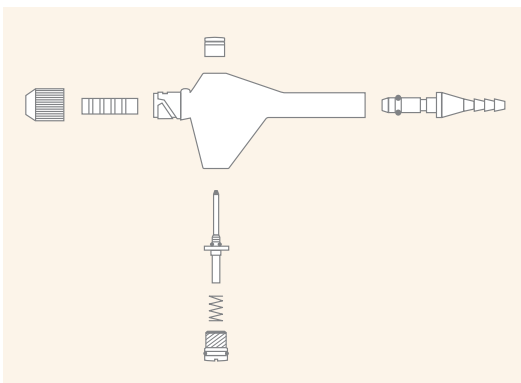

To clean, immerse the pieces in mild laboratory detergent, but do not use abrasives, as a roughened surface may affect the smooth operation of the control valve. **NOTE:** When working with salt-rich solutions, rinse out the aspirator handpiece with distilled water after use to avoid build-up of dried deposits.

Apply a thin coat of Dupont Molykote® BG-87 lubricant as needed to the control valve to keep the action smooth.

## 6.0 Aspirator Attachment Options

### Single-channel Adapter

The single-channel adapter is included with the Corning® Aspirator and is for use with standard 1 to 200  $\mu$ L disposable pipet tips.



### 8-channel Adapter

The 8-channel adapter fits standard 1 to 200  $\mu$ L disposable pipet tips, and is available for use with 96-well microplates (sold separately).



## 7.0 Chemical Compatibility

Avoid prolonged contact (days or weeks) with:

- ▶ Concentrated inorganic acids
- ▶ Sodium hypochlorite
- ▶ Methylene chloride
- ▶ Concentrated aldehydes
- ▶ Other halogenated hydrocarbons

Resistant to:

- ▶ DMSO
- ▶ Ethanol/methanol
- ▶ Dimethylformamide
- ▶ Acetone

### NOTES:

- ▶ Flushing the aspirator with ethanol immediately after contact with organic solvents is the best safeguard in all cases.
- ▶ For O-ring replacement, use fluorocarbon O-rings only.

## 8.0 Spare Parts

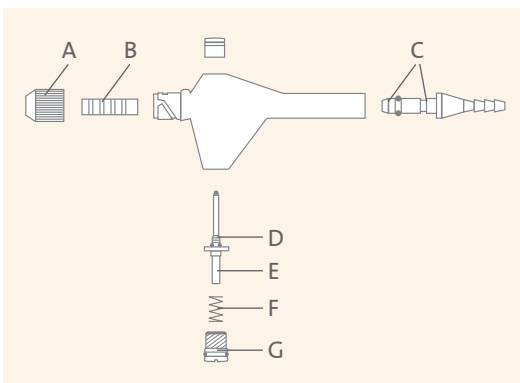

Item	Cat. No.	Description	Qty/Pk
–	4931	8-channel adapter	1
–	155850	Single-channel adapter	1
A	155855	Quick-locking screw, orange	1
B	155505	Rubber adapter for glass pipets	1
C	155830	O-ring, 6.75 x 1.78 mm FKM for end piece	1
D	155805	O-ring, 2.57 x 1.78 mm FKM 60 shore A for valve plunger	1
E	155605	Tappet grey with O-ring, valve plunger	1
F	151230	Plunger spring	1
G	155800	O-ring, 9.25 x 1.78 mm FKM for base screw	1



## 9.0 Limited Warranty

Corning Incorporated (Corning) warrants that this product will be free from defects in material and workmanship for a period of one (1) year from date of purchase. CORNING DISCLAIMS ALL OTHER WARRANTIES WHETHER EXPRESSED OR IMPLIED, INCLUDING ANY IMPLIED WARRANTIES OF MERCHANTABILITY OR OF FITNESS FOR A PARTICULAR PURPOSE. Corning's sole obligation shall be to repair or replace, at its option, any product or part thereof that proves defective in material or workmanship within the warranty period, provided the purchaser notifies Corning of any such defect. Corning is not liable for any incidental or consequential damages, commercial loss or any other damages from the use of this product.

This warranty is valid only if the product is used for its intended purpose and within the guidelines specified in the supplied instruction manual. This warranty does not cover damage caused by accident, neglect, misuse, improper service, natural forces or other causes not arising from defects in original material or workmanship. This warranty does not cover O-rings, rubber adapter or damage to paint or finish. Claims for transit damage should be filed with the transportation carrier.

In the event this product fails within the specified period of time because of a defect in material or workmanship, contact Corning Customer Service at: USA/Canada 1.800.492.1110, outside the U.S. +1.978.442.2200, visit [www.corning.com/lifesciences](http://www.corning.com/lifesciences), or contact your local support office.

Corning's Customer Service team will help arrange local service where available or coordinate a return authorization number and shipping instructions. Products received without proper authorization will be returned. All items returned for service should be sent postage prepaid in the original packaging or other suitable carton, padded to avoid damage. Corning will not be responsible for damage incurred by improper packaging. Corning may elect for onsite service for larger equipment.

Some states do not allow limitation on the length of implied warranties or the exclusion or limitation of incidental or consequential damages. This warranty gives you specific legal rights. You may have other rights which vary from state to state.

No individual may accept for, or on behalf of Corning, any other obligation of liability, or extend the period of this warranty.

For your reference, make a note of the serial and model number, date of purchase, and supplier here.

Serial No. \_\_\_\_\_

Date Purchased \_\_\_\_\_

Model No. \_\_\_\_\_

Supplier \_\_\_\_\_

**Warranty/Disclaimer:** Unless otherwise specified, all products are for research use or general laboratory use only.\* Not intended for use in diagnostic or therapeutic procedures. Not for use in humans. These products are not intended to mitigate the presence of microorganisms on surfaces or in the environment, where such organisms can be deleterious to humans or the environment. Corning Life Sciences makes no claims regarding the performance of these products for clinical or diagnostic applications. \*For a listing of US medical devices, regulatory classifications or specific information on claims, visit [www.corning.com/resources](http://www.corning.com/resources).

*Corning's products are not specifically designed and tested for diagnostic testing. Many Corning products, though not specific for diagnostic testing, can be used in the workflow and preparation of the test at the customer's discretion. Customers may use these products to support their claims. We cannot make any claims or statements that our products are approved for diagnostic testing either directly or indirectly. The customer is responsible for any testing, validation, and/or regulatory submissions that may be required to support the safety and efficacy of their intended application.*

# CORNING

Corning Incorporated

*Life Sciences*

[www.corning.com/lifesciences](http://www.corning.com/lifesciences)

## NORTH AMERICA

t 800.492.1110

t 978.442.2200

## ASIA/PACIFIC

**Australia/New Zealand**

t 61 427286832

**Chinese Mainland**

t 86 21 3338 4338

**India**

t 91 124 4604000

**Japan**

t 81 3-3586 1996

**Korea**

t 82 2-796-9500

**Singapore**

t 65 6572-9740

**Taiwan**

t 886 2-2716-0338

## EUROPE

[CSEurope@corning.com](mailto:CSEurope@corning.com)

**France**

t 0800 916 882

**Germany**

t 0800 101 1153

**The Netherlands**

t 20 655 79 28

**United Kingdom**

t 0800 376 8660

**All Other European  
Countries**

t +31 (0) 206 59 60 51

## LATIN AMERICA

[grupoLA@corning.com](mailto:grupoLA@corning.com)

**Brasil**

t 55 (11) 3089-7400

**Mexico**

t (52-81) 8158-8400

For a listing of trademarks, visit [www.corning.com/clstrademarks](http://www.corning.com/clstrademarks).  
All other trademarks are the property of their respective owners.

© 2008, 2023 Corning Incorporated. All rights reserved.  
1/23 CLS-AN-725DOC REV1